

SKF SNH plummer block housings



SKF SNH plumber block housings

© SKF is a registered trademark of SKF Group.

© SKF Group 2017

The contents of this publication are the copyright of the publisher and may not be reproduced (even extracts) unless prior written permission is granted. Every care has been taken to ensure the accuracy of the information contained in this publication but no liability can be accepted for any loss or damage whether direct, indirect or consequential arising out of the use of the information contained herein.

PUB BU/P9 17604 EN · September 2017

Certain image(s) used under license from Shutterstock.com

SKF SNH plummer block housings



Bearing types

- Self-aligning ball bearings
- Spherical roller bearings

Bearing dimension series

- 02, 03, 22, 23, 32

Shaft diameter range

- 25 – 160 mm

Typical shaft-bearing combination

- Plain shaft with bearing on an adapter sleeve
- Stepped shaft with bearing on a cylindrical seat

Seals

- Four Lip Seal
- Labyrinth Seal

Lubrication

- Grease

Materials

- Grey cast iron - FG 260 Grade
- Spheroidal graphite cast iron - 400/18 Grade

Mounting

- Two-bolt mounting
- Four-bolt mounting

Compliance to standards

- ISO 113
(two-bolt plummer block housings)

Paint

- Black (RAL 9005) - water based alkyd/ acryl paint

SKF SNH plummer block housings 2, 5 and 6 series

Designation system	5	Product tables	
Standard housing design	6	SKF SNH plummer block housings for bearings with adapter sleeve	18
Design features	7	SKF SNH plummer block housings for bearings on cylindrical seat	28
Housing variants	8		
Materials	8		
Dimension standards	8		
Interchangeability	8		
Attachment bolt holes	8		
Sealing solutions	10		
Four lip seals	10		
Labyrinth seals	10		
End covers	10		
Design considerations	11		
Operating temperature	11		
Attachment bolt recommendations	11		
Additional housing support	11		
Lubrication	13		
Initial grease fill	13		
Relubrication	13		

Designation system

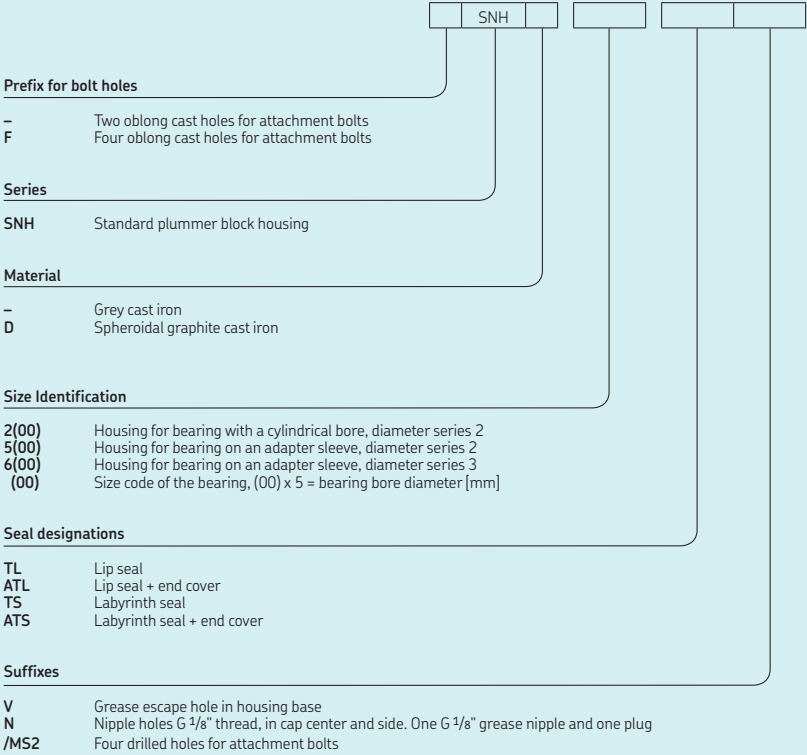

Designation system for locating rings

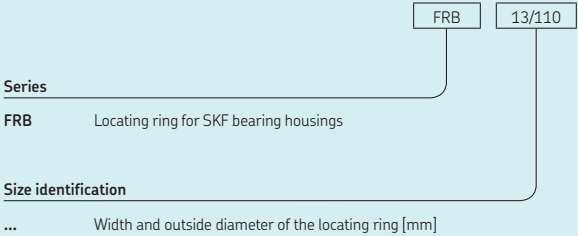

SKF SNH plummer block housings

Standard housing design

SNH plummer (pillow) block housings in the 2, 5 and 6 series are split housings consisting of a cap and base (→ **fig. 1**). They have two holes cast into the base for attachment bolts. The housings are designed to enable a wider choice of bearings and seals as well as a variety of shaft-bearing combinations.

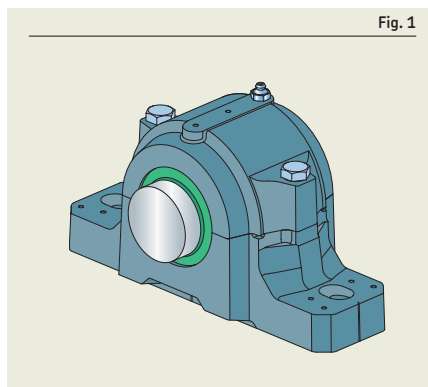

Design features



Dimples to locate accessories and improved lubrication facilities

Dimples cast into the housing cap indicate where grease fittings and condition monitoring sensors can be mounted for maximum effectiveness.

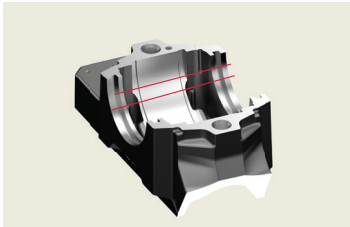

Grease level marking

To avoid over-filling, markings at each corner inside the housing base indicate the proper grease level for an initial 20% or 40% fill of the free space between housing and bearing.

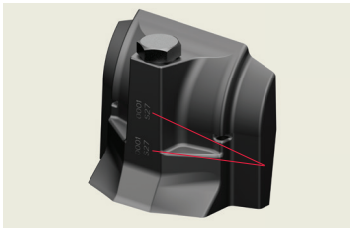

Improved markings on the housings

The housing cap and base are individually marked. The serial number in both the parts helps avoid mismatch. The enhanced designation on the housing cap improves readability & traceability

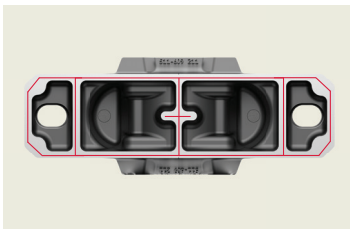

Better heat dissipation

There are additional ribs in the base at sides and center which increases the contact area between base and the support surface. This reduces operating temperatures and increases the service life of the bearings, seals and lubricant.



Simple mounting and dismounting

To simplify mounting and make alignment more accurate, lines indicating the centre of the bearing seat and housing bore axis are cast into the housing base. Dimples indicate the position for dowel pins.

Housing material

Grey cast iron, FG 260 as per IS 210

SNH plummer blocks are made of grey cast iron. For applications where housings of greater strength are needed, SKF manufactures a range of plummer block housings of SNH design in spheroidal graphite cast iron. These housings carry the designation SNHD. All dimensions of these housings are identical to those of the same size of SNH housing in grey cast iron material. They can therefore be fitted with the same bearings and accessories.

Dimension standards

Boundary dimensions are in accordance with ISO 113 for two-bolt plummer block housings.

Interchangeability

SNH plummer block housings in the 2, 5 and 6 series are dimensionally interchangeable with the earlier SN, SNA series and existing SNL/SE series housings.

Paint, corrosion protection

SNL housings are painted black (RAL 9005) using a water based alkyd/acryl paint. The paint protects the housing in accordance with ISO 12944-2, corrosivity category C2 (i.e. exterior atmospheres with low level of pollution, interior atmospheres where condensation may occur). The paint is not affected by most lubricating and engine oils, cutting fluids or alkaline washing chemicals.

Attachment bolt holes

Two cast holes

SNH housings are provided with two cast holes as standard.

Four cast holes

SNH plummer block housings can be also be supplied with four cast holes configuration. Dimensions are listed in table 1. These housings are designated FSNH.

Four drilled holes

All two-bolt housings have dimples, which mark the bolt hole positions for four-bolt mounting where users can drill holes directly. For dimension details, please contact SKF application engineering service.

Table 1

Dimensions for four cast attachment bolt holes

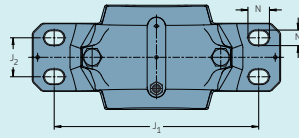

Housing size 2 series	5 series	6 series	Dimensions [mm]		J1	J2
			N	N1		
(F)SNH 211	(F)SNH 511	(F)SNH 609	20	15	210	35
(F)SNH 212	(F)SNH 512	(F)SNH 610	20	15	210	35
(F)SNH 213	(F)SNH 513	(F)SNH 611	20	15	230	40
(F)SNH 215	(F)SNH 515	(F)SNH 612	20	15	230	40
(F)SNH 216	(F)SNH 516	(F)SNH 613	24	18	260	50
(F)SNH 217	(F)SNH 517	–	24	18	260	50
(F)SNH 218	(F)SNH 518	(F)SNH 615	24	18	290	50
(F)SNH 219	(F)SNH 519	(F)SNH 616	24	18	290	50
(F)SNH 220	(F)SNH 520	(F)SNH 617	24	18	320	60
(F)SNH 222	(F)SNH 522	(F)SNH 619	24	18	350	70
(F)SNH 224	(F)SNH 524	(F)SNH 620	24	18	350	70
(F)SNH 226	(F)SNH 526	–	28	22	380	70
(F)SNH 228	(F)SNH 528	–	32	26	420	80
(F)SNH 230	(F)SNH 530	–	32	26	450	90
(F)SNH 232	(F)SNH 532	–	32	26	470	90

Sealing solutions

The standard seals supplied by SKF are four lip seals. SKF SNH housings can also be equipped with labyrinth seals which are available on request.

Four Lip seals

Four lip seals are manufactured using a unique process that improves the finish of the contact surfaces so that there is less friction and heat generated by the seals. The lip seals are split so that they can be installed easily. The permissible operating temperature range for the seal is between -40° and $+100^{\circ}$.

The permissible angular misalignment for seals mounted on shafts ≤ 100 mm in diameter is approximately 1° and approximately $0,5^{\circ}$ for larger shafts. The maximum circumferential speed for lip seals is 13 m/s.

Labyrinth seals

For high speed applications, SKF recommends using labyrinth seals. A labyrinth seal consists of a labyrinth ring, mounted on the shaft, which forms a multi-stage labyrinth with the seal grooves in the housing. Nitrile rubber cords, supplied with the rings, hold the rings in place on the shaft. The permissible operating temperature range for the seal is between -40° and $+100^{\circ}$ and permissible angular misalignment is $0,3^{\circ}$.

End covers

If the bearing is mounted at the end of a shaft, the housing should be blanked off by means of a standard end cover. It is to be inserted into the seal groove of the housing. The end covers are made of polymer. Please refer designation system for ordering information.

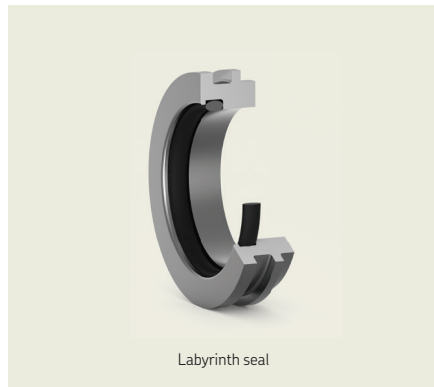

Design considerations

Operating temperature

The permissible operating temperature is mainly limited by the seals and the lubricant in the bearing. For temperature limits of SKF bearings and lubricants, refer to the product information available online at skf.com/bearings. The housing material does not have any additional temperature limits, except for very low temperature applications where impact strength could be a factor.

Attachment bolt recommendations

In typical applications, 8.8 class hexagon head bolts in accordance with ISO 4014 can be used together with washers. If the load does not act perpendicular toward the base, it may be necessary to use stronger 10.9 class bolts. SKF housings can withstand loads resulting from tightening the attachment bolts to the torque values recommended by bolt manufacturers (→ **table 2**). They are valid for oiled, but otherwise untreated, thread surfaces. SKF cannot guarantee that tightening to the recommended value will provide sufficient anchoring. Make sure that attachment bolts, dowels or stops and a sufficiently strong support can accommodate all occurring loads.

Additional housing support

When a housing is subjected to loads acting parallel to the support surface, it may be necessary to pin the housing to the support surface or to provide a stop to counter the load. When loads act at angles between 55° and 120°, or when the axial loads are higher, the housing should be pinned to the support surface or a stop should be provided to counter the load. The dowel pins or stop should be sufficiently strong to accommodate the loads acting parallel to the support surface. Dimples are provided on housing base surface to identify the dowel pin w

SKF SNH plummer block housings

Table 2

Torque values for cap bolts and attachment bolts

Housing size 2 series	5 series	6 series	Cap bolt Size	Tightening torque Torque [Nm]	Attachment bolts Size	Torque [Nm]
SNH 207	SNH 507	SNH 606	M 10x50	50	M 12	80
SNH 208	SNH 508	SNH 607	M 10x50	50	M 12	80
SNH 209	SNH 509	–	M 10x50	50	M 12	80
SNH 210	SNH 510	SNH 608	M 10x55	50	M 12	80
(F)SNH 211	(F)SNH 511	(F)SNH 609	M 12x60	80	M 16	200
(F)SNH 212	(F)SNH 512	(F)SNH 610	M 12x60	80	M 16	200
(F)SNH 213	(F)SNH 513	(F)SNH 611	M 12x65	80	M 16	200
(F)SNH 215	(F)SNH 515	(F)SNH 612	M 12x65	80	M 16	200
(F)SNH 216	(F)SNH 516	(F)SNH 613	M 12x70	80	M 20	385
(F)SNH 217	(F)SNH 517	–	M 12x80	80	M 20	385
(F)SNH 218	(F)SNH 518	(F)SNH 615	M 16x90	150	M 20	385
–	(F)SNH 519	(F)SNH 616	M 16x90	150	M 20	385
–	(F)SNH 520	(F)SNH 617	M 20x100	200	M 24	665
–	(F)SNH 522	(F)SNH 619	M 20x100	200	M 24	665
–	(F)SNH 524	(F)SNH 620	M 20x110	200	M 24	665
–	(F)SNH 526	–	M 24x130	350	M 24	665
–	(F)SNH 528	–	M 24x130	350	M 30	1,310
–	(F)SNH 530	–	M 24x130	350	M 30	1,310
–	(F)SNH 532	–	M 24x130	350	M 30	1,310

Lubrication

SNH plummer (pillow) block housings in the 2, 5 and 6 series are intended for grease lubrication.

The lubricant should be selected based on the operating conditions of the bearing. For additional information about lubricant selection, refer to the product information available online at skf.com.

Initial grease fill

If no other requirements exist, the free space in the bearing should be completely filled with grease and the free space in the housing should be filled to 20% to 40% of its volume. A 40% grease fill is required when bearings have to be relubricated from the side, while a 20% grease fill is used when bearings are relubricated via the outer ring.

For highly contaminated environments and slow speeds, fill the housing to 70% – 80%. Quantities for 20% and 40% grease fills are listed **table 3**. The values are valid for a typical lithium grease (about 0,95 g/cm³).

In most applications, the initial grease fill will adequately lubricate the bearing until the grease is exchanged during the next planned inspection.

Relubrication

SNH plummer block housings enable relubrication of the incorporated bearings (→ **fig. 2**).

SNH housings have one hole that have been drilled and tapped for an G 1/8" grease fitting. The grease fitting is supplied with the housing. If a larger grease fitting or other equipment has to be used, an adapter to change to a G 1/4" thread is to be used.

Dimples cast into the top of the housing cap indicate alternative positions where holes can be drilled and tapped to accommodate additional grease fittings for bearing.

Table 3
Initial grease fill

Housing size			Initial fill	
2 series	5 series	6 series	20%	40%
–			g	
SNH 207	SNH 507	SNH 606	30	50
SNH 208	SNH 508	SNH 607	35	60
SNH 209	SNH 509	–	40	65
SNH 210	SNH 510	SNH 608	45	75
(F)SNH 211	(F)SNH 511	(F)SNH 609	60	100
(F)SNH 212	(F)SNH 512	(F)SNH 610	90	150
(F)SNH 213	(F)SNH 513	(F)SNH 611	110	180
(F)SNH 215	(F)SNH 515	(F)SNH 612	140	230
(F)SNH 216	(F)SNH 516	(F)SNH 613	170	280
(F)SNH 217	(F)SNH 517	–	200	330
(F)SNH 218	(F)SNH 518	(F)SNH 615	260	430
(F)SNH 219	(F)SNH 519	(F)SNH 616	300	480
(F)SNH 220	(F)SNH 520	(F)SNH 617	390	630
(F)SNH 222	(F)SNH 522	(F)SNH 619	530	850
(F)SNH 224	(F)SNH 524	(F)SNH 620	630	1,000
(F)SNH 226	(F)SNH 526	–	700	1,100
(F)SNH 228	(F)SNH 528	–	900	1,400
(F)SNH 230	(F)SNH 530	–	1,100	1,700
(F)SNH 232	(F)SNH 532	–	1,300	2,000

Fig. 2

SNH housing up to size 218 or 522

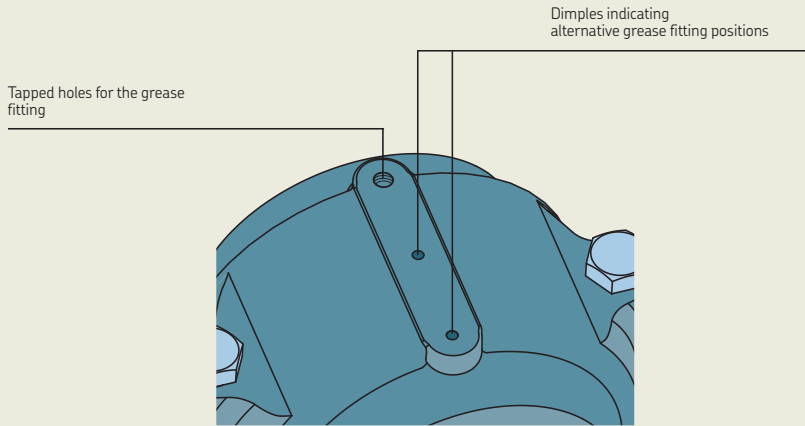

SNH housing from size 524 and above

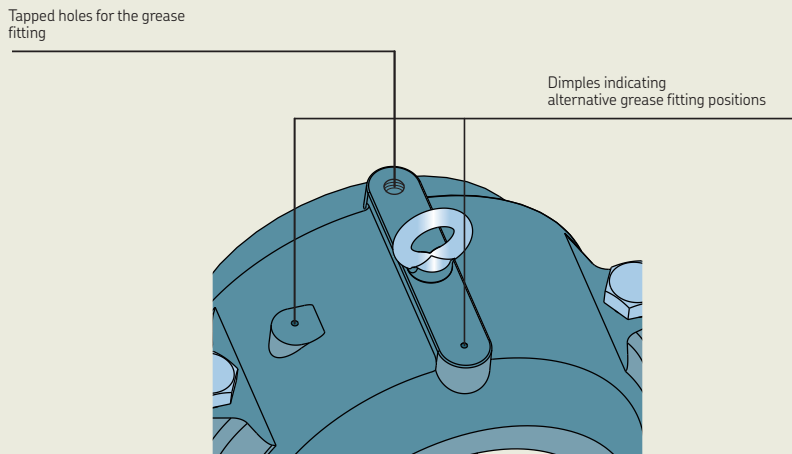

Relubrication via the outer ring

SNH housing with the central lubrication port can be ordered. This central port can be used to relubricate spherical roller bearings with a relubrication feature (a lubrication groove and holes in the outer ring) (→ **fig. 3**). When applying grease via the relubrication feature, the shaft should be rotating. Narrow bearings (dimension series 13 and 22) in the locating position can be displaced axially, so that the relubrication groove in the bearing does not line up with the relubrication hole in the housing cap. Make sure the bearing is sufficiently centered when relubricating.

Relubrication from the side

When relubricating from the side, which is typically necessary for self-aligning ball bearings, the standard side lubrication port in the housing should be used. When bearings mounted on an adapter sleeve have to be relubricated from the side, the grease should be introduced from the side opposite the lock nut. When bearings mounted at the end of a shaft have to be relubricated from the side, the grease should be applied at the point closest to the end cover.

Grease escape hole

When lip seals are used, grease cannot escape via the seals. If relubrication is required, the housing should have a grease escape hole.

SNH housings can be supplied with a grease escape hole (suffix V).

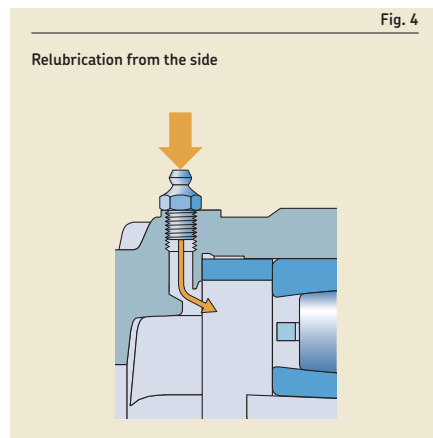
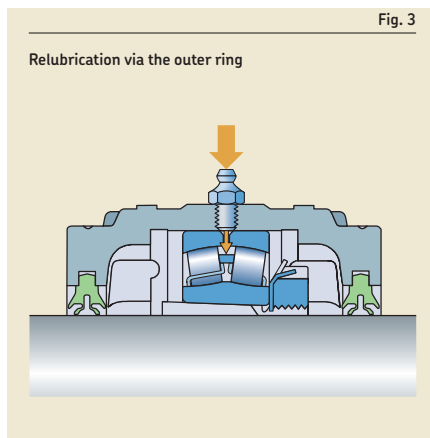

New SKF range of housings and accessories

World-class quality at competitive price

In response to market demand and our commitment towards 'Make in India' SKF now launches its new range of housings and accessories. Being manufactured in India, these housings and accessories have the advantage of being cost competitive, easily available and have better service levels.

These robust housings and accessories are developed to reduce the risk of deforming the bearings. The product is designed to offer maximum service life potential to the incorporated bearing.



COMPETITIVE
PRODUCT
OFFERING

MADE IN INDIA

WORLD-CLASS
QUALITY



SKF SNH plummer block housings for bearings with adapter sleeve

d_a 25 – 40 mm

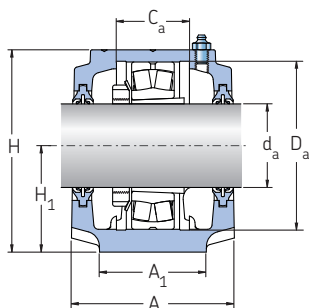

Housing with lip seals,
Type TL

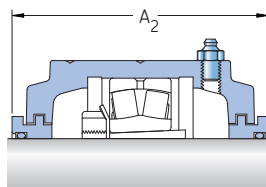

Housing with labyrinth seals,
Type TS

Shaft dia d_a	Housing with both side lip seals	Housing with lip seal + End Cover	Housing with both side labyrinth seals	Housing with labyrinth seal + End Cover	Bearing	Adapter Sleeve ¹⁾	Locating ring ²⁾
mm							
25	-	-	SNH 606 TS	SNH 606 ATS	1306 EKTN9	H 360	FRB 7.5/72
					2306 K	H 2306	FRB 3.5/72
					21306 CCK	H 306	FRB 7.5/72
30	SNH 507 TL	SNH 507 ATL	SNH 507 TS	SNH 507 ATS	1207 EKTN9	H 207	FRB 8.5/72
					2207 EKTN9	H 307	FRB 5.5/72
					22207 EK	H 307	FRB 5.5/72
30	SNH 607 TL	SNH 607 ATL	SNH 607 TS	SNH 607 ATS	1307 EKTN9	H 307	FRB 9/80
					2307 EKTN9	H 2307	FRB 4/80
					21307 CCK	H 307	FRB 9/80
35	SNH 508 TL	SNH 508 ATL	SNH 508 TS	SNH 508 ATS	1208 EKTN9	H 208	FRB 10.5/80
					2208 EKTN9	H 308	FRB 8/80
					22208 EK	H 308	FRB 8/80
35	SNH 608 TL	SNH 608 ATL	SNH 608 TS	SNH 608 ATS	1308 EKTN9	H 308	FRB 9/90
					2308 EKTN9	H 2308	FRB 4/90
					21308 EK	H 308	FRB 9/90
					22308 EK	H 2308	FRB 4/90
40	SNH 509 TL	SNH 509 ATL	SNH 509 TS	SNH 509 ATS	1209 EKTN9	H 209	FRB 5.5/85
					2209 EKTN9	H 309	FRB 3.5/85
					22209 EK	H 309	FRB 3.5/85
40	SNH 609 TL	SNH 609 ATL	SNH 609 TS	SNH 609 ATS	1309 EKTN9	H 309	FRB 9.5/100
					2309 EKTN9	H 2309	FRB 4/100
					21309 EK	H 309	FRB 9.5/100
					22309 EK	H 2309	FRB 4/100

¹⁾ The adapter sleeve fits the bearing in the same line only.

²⁾ The locating ring fits the bearing in the same line only. Two locating rings are required for each housing.

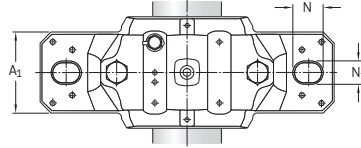
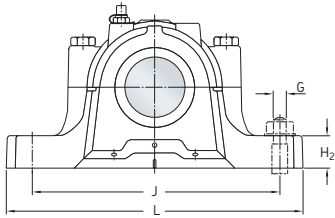

Shaft dia d_a	A	A_1	A_2	C_a	D_a	H	H_1	H_2	J	L	N	N_1	G	Housing Mass
mm														kg
25	83	52	94	34	72	93	50	22	150	185	20	15	12	2,20
30	83	52	94	34	72	93	50	22	150	185	20	15	12	2,20
30	85	60	97	39	80	108	60	25	170	205	20	15	12	2,90
35	85	60	97	39	80	108	60	25	170	205	20	15	12	2,90
35	90	60	102	41	90	113	60	25	170	205	20	15	12	3,20
40	85	60	97	30	85	109	60	25	170	205	20	15	12	2,90
40	95	70	107	44	100	128	70	28	210	255	24	18	16	4,40

SKF SNH plummer block housings for bearings with adapter sleeve

d_a 45–55 mm

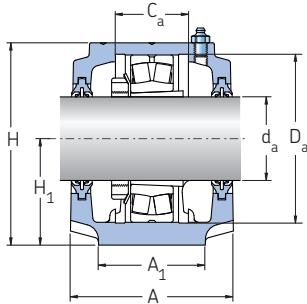

Housing with lip seals,
Type TL

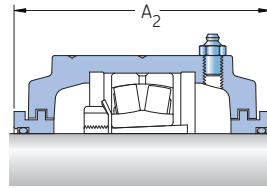

Housing with labyrinth seals,
Type TS

Shaft dia d_a	Housing with both side lip seals	Housing with lip seal + End Cover	Housing with both side labyrinth seals	Housing with labyrinth seal + End Cover	Bearing	Adapter Sleeve ¹⁾	Locating ring ²⁾
mm							
45	SNH 510 TL	SNH 510 ATL	SNH 510 TS	SNH 510 ATS	1210 EKTN9	H 210	FRB 10.5/90
					2210 EKTN9	H 310	FRB 9/90
					22210 EK	H 310	FRB 9/90
45	SNH 610 TL	SNH 610 ATL	SNH 610 TS	SNH 610 ATS	1310 EKTN9	H 310	FRB 10.5/110
					2310 K	H 2310	FRB 4/110
					21310 EK	H 310	FRB 10.5/110
					22310 EK	H 2310	FRB 4/110
50	SNH 511 TL	SNH 511 ATL	SNH 511 TS	SNH 511 ATS	1211 EKTN9	H 211	FRB 11.5/100
					2211 EKTN9	H 311	FRB 9.5/100
					22211 EK	H 311	FRB 9.5/100
50	SNH 611 TL	SNH 611 ATL	SNH 611 TS	SNH 611 ATS	1311 EKTN9	H 311	FRB 11/120
					2311 K	H 2311	FRB 4/120
					21311 EK	H 311	FRB 11/120
					22311 EK	H 2311	FRB 4/120
55	SNH 512 TL	SNH 512 ATL	SNH 512 TS	SNH 512 ATS	1212 EKTN9	H 212	FRB 13/110
					2212 EKTN9	H 312	FRB 10/110
					22212 EK	H 312	FRB 10/110
55	SNH 612 TL	SNH 612 ATL	SNH 612 TS	SNH 612 ATS	1312 EKTN9	H 312	FRB 12.5/130
					2312 K	H 2312	FRB 5/130
					21312 EK	H 312	FRB 12.5/130
					22312 EK	H 2312	FRB 5/130

¹⁾ The adapter sleeve fits the bearing in the same line only.

²⁾ The locating ring fits the bearing in the same line only. Two locating rings are required for each housing.

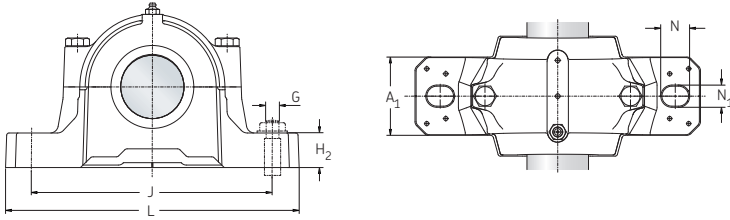

Shaft dia d_a	A	A_1	A_2	C_a	D_a	H	H_1	H_2	J	L	N	N_1	G	Housing Mass
mm														kg
45	90	60	102	41	90	113	60	25	170	205	20	15	12	3,20
45	105	70	117	48	110	134	70	30	210	255	24	18	16	5,10
50	95	70	107	44	100	128	70	28	210	255	24	18	16	4,40
50	110	80	122	51	120	150	80	30	230	275	24	18	16	6,50
55	105	70	117	48	110	134	70	30	210	255	24	18	16	5,10
55	115	80	127	56	130	156	80	30	230	280	24	18	16	7,00

SKF SNH plummer block housings for bearings with adapter sleeve

d_a 60 – 70 mm

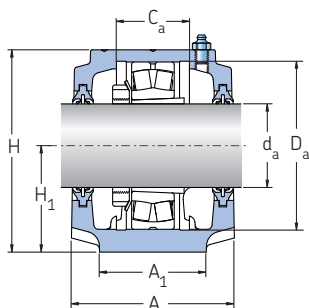

Housing with lip seals,
Type TL

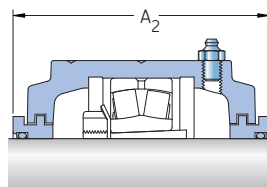

Housing with labyrinth seals,
Type TS

Shaft dia d_a	Housing with both side lip seals	Housing with lip seal + End Cover	Housing with both side labyrinth seals	Housing with labyrinth seal + End Cover	Bearing	Adapter Sleeve ¹⁾	Locating ring ²⁾
mm							
60	SNH 513 TL	SNH 513 ATL	SNH 513 TS	SNH 513 ATS	1213 EKTN9	H 213	FRB 14/120
					2213 EKTN9	H 313	FRB 10/120
					22213 EK	H 313	FRB 10/120
60	SNH 613 TL	SNH 613 ATL	SNH 613 TS	SNH 613 ATS	1313 EKTN9	H 313	FRB 12.5/140
					2313 K	H 2313	FRB 5/140
					21313 EK	H 313	FRB 12.5/140
					22313 EK	H 2313	FRB 5/140
65	SNH 515 TL	SNH 515 ATL	SNH 515 TS	SNH 515 ATS	1215 K	H 215	FRB 15.5/130
					2215 EKTN9	H 315	FRB 12.5/130
					22215 EK	H 315	FRB 12.5/130
65	SNH 615 TL	SNH 615 ATL	SNH 615 TS	SNH 615 ATS	1315 K	H 315	FRB 14/160
					2315 K	H 2315	FRB 5/160
					21315 EK	H 315	FRB 14/160
					22315 EK	H 2315	FRB 5/160
70	SNH 516 TL	SNH 516 ATL	SNH 516 TS	SNH 516 ATS	1216 K	H 216	FRB 16/140
					2216 EKTN9	H 316	FRB 12.5/140
					22216 EK	H 316	FRB 12.5/140
70	SNH 616 TL	SNH 616 ATL	SNH 616 TS	SNH 616 ATS	1316 K	H 316	FRB 14.5/170
					2316 K	H 2316	FRB 5/170
					21316 EK	H 316	FRB 14.5/170
					22316 EK	H 2316	FRB 5/170

¹⁾ The adapter sleeve fits the bearing in the same line only.

²⁾ The locating ring fits the bearing in the same line only. Two locating rings are required for each housing.

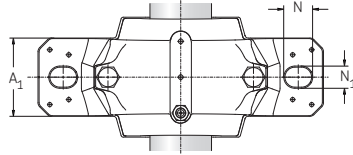
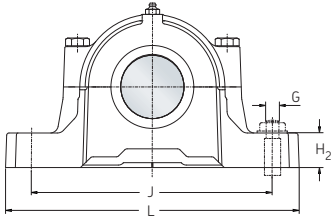

Shaft dia d_a	A	A_1	A_2	C_a	D_a	H	H_1	H_2	J	L	N	N_1	G	Housing Mass
mm														kg
60	110	80	122	51	120	150	80	30	230	275	24	18	16	6,50
60	120	90	138	58	140	177	95	32	260	315	28	22	20	9,50
65	115	80	127	56	130	156	80	30	230	280	24	18	16	7,00
65	140	100	158	65	160	194	100	35	290	345	28	22	20	12,5
70	120	90	138	58	140	177	95	32	260	315	28	22	20	9,50
70	145	100	163	68	170	212	112	35	290	345	28	22	20	13,7

SKF SNH plummer block housings for bearings with adapter sleeve

d_a 75–90 mm

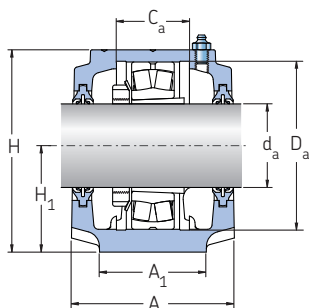

Housing with lip seals,
Type TL

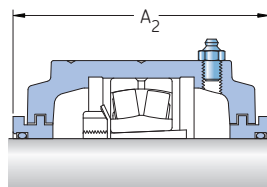

Housing with labyrinth seals,
Type TS

Shaft dia d_a	Housing with both side lip seals	Housing with lip seal + End Cover	Housing with both side labyrinth seals	Housing with labyrinth seal + End Cover	Bearing	Adapter Sleeve ¹⁾	Locating ring ²⁾
mm							
75	SNH 517 TL	SNH 517 ATL	SNH 517 TS	SNH 517 ATS	1217 K	H 217	FRB 16.5/150
					2217 K	H 317	FRB 12.5/150
					22217 EK	H 317	FRB 12.5/150
75	SNH 617 TL	SNH 617 ATL	SNH 617 TS	SNH 617 ATS	1317 K	H 317	FRB 14.5/180
					2317 K	H 2317	FRB 5/180
					21317 EK	H 317	FRB 14.5/180
					22317 EK	H 2317	FRB 5/180
80	SNH 518 TL	SNH 518 ATL	SNH 518 TS	SNH 518 ATS	1218 K	H 218	FRB 17.5/160
					2218 K	H 318	FRB 12.5/160
					22218 EK	H 318	FRB 12.5/160
					23218 CCK/W33	H 2318	FRB 6.25/160
85	SNH 519 TL	SNH 519 ATL	SNH 519 TS	SNH 519 ATS	1219 K	H 219	FRB 18/170
					2219 KM	H 319	FRB 12.5/170
					22219 EK	H 319	FRB 12.5/170
85	-	-	SNH 619 TS	SNH 619 ATS	1319 K	H 319	FRB 17.5/200
					2319 KM	H 2319	FRB 6.5/200
					21319 EK	H 319	FRB 17.5/200
					22319 EK	H 2319	FRB 6.5/200
90	SNH 520 TL	SNH 520 ATL	SNH 520 TS	SNH 520 ATS	1220 K	H 220	FRB 18/180
					2220 KM	H 330	FRB 12/180
					22220 EK	H 320	FRB 12/180
					23220 CCK/W33	H 2320	FRB 4.85/180

¹⁾ The adapter sleeve fits the bearing in the same line only.

²⁾ The locating ring fits the bearing in the same line only. Two locating rings are required for each housing.

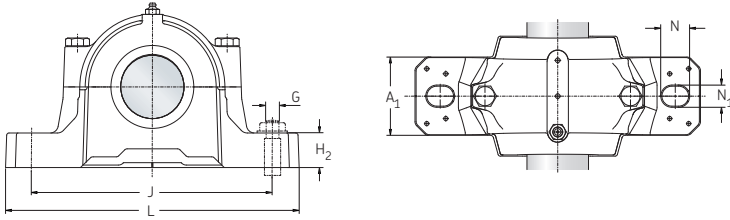

Shaft dia d_a	A	A_1	A_2	C_a	D_a	H	H_1	H_2	J	L	N	N_1	G	Housing Mass
mm														kg
75	125	90	143	61	150	183	95	32	260	320	28	22	20	10,0
75	160	110	178	70	180	218	112	40	320	380	32	26	24	17,6
80	140	100	158	65	160	194	100	35	290	345	28	22	20	12,5
85	145	100	163	68	170	212	112	35	290	345	28	22	20	13,7
85	175	120	191	80	200	242	125	45	350	410	32	26	24	22,0
90	160	110	178	70	180	218	112	40	320	380	32	26	24	17,6

SKF SNH plummer block housings for bearings with adapter sleeve

d_a 90–140 mm

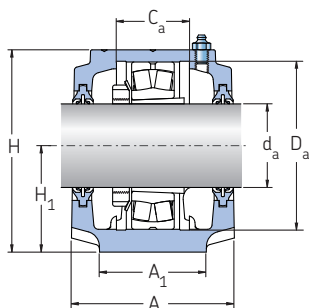

Housing with lip seals,
Type TL

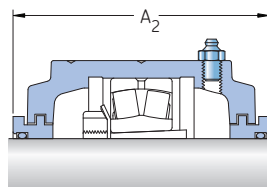

Housing with labyrinth seals,
Type TS

Shaft dia d_a	Housing with both side lip seals	Housing with lip seal + End Cover	Housing with both side labyrinth seals	Housing with labyrinth seal + End Cover	Bearing	Adapter Sleeve ¹⁾	Locating ring ²⁾
mm							
90	-	-	SNH 620 TS	SNH 620 ATS	1320 K	H 320	FRB 19.5/215
					2320 K	H 2320	FRB 6.5/215
					21320 EK	H 320	FRB 19.5/215
					22320 EK	H 2320	FRB 6.5/215
100	SNH 522 TL	SNH 522 ATL	SNH 522 TS	SNH 522 ATS	1222 K	H 222	FRB 21/200
					2222 KM	H 322	FRB 13.5/200
					22222 EK	H 322	FRB 13.5/200
					23222 CCK/W33	H 2322	FRB 5.1/200
110	SNH 524 TL	SNH 524 ATL	SNH 524 TS	SNH 524 ATS	1224 KM	H 3024	FRB 22/215
					22224 EK	H 3124	FRB 14/215
					23224 CCK/W33	H 2324	FRB 5/215
115	SNH 526 TL	SNH 526 ATL	SNH 526 TS	SNH 526 ATS	22226 EK	H 3126	FRB 13/230
					23226 CCK/W33	H 2326	FRB 5/230
125	SNH 528 TL	SNH 528 ATL	SNH 528 TS	SNH 528 ATS	22228 CCK/W33	H 3128	FRB 15/250
					23228 CCK/W33	H 2328	FRB 5/250
135	SNH 530 TL	SNH 530 ATL	SNH 530 TS	SNH 530 ATS	22230 CCK/W33	H 3130	FRB 16.5/270
					23230 CCK/W33	H 2330	FRB 5/270
140	SNH 532 TL	SNH 532 ATL	SNH 532 TS	SNH 532 ATS	22232 CCK/W33	H 3132	FRB 17/290

¹⁾ The adapter sleeve fits the bearing in the same line only.

²⁾ The locating ring fits the bearing in the same line only. Two locating rings are required for each housing.

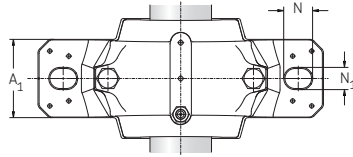
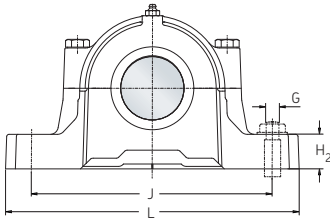

Shaft dia d_a	A	A ₁	A ₂	C _a	D _a	H	H ₁	H ₂	J	L	N	N ₁	G	Housing Mass
mm														kg
90	185	120	199	86	215	271	140	45	350	410	32	26	24	26,2
100	175	120	191	80	200	242	125	45	350	410	32	26	24	22,0
110	185	120	199	86	215	271	140	45	350	410	32	26	24	26,2
115	190	130	208	90	230	290	150	50	380	445	35	28	24	33,0
125	205	150	223	98	250	302	150	50	420	500	42	35	30	40,0
135	220	160	241	106	270	323	160	60	450	530	42	35	30	49,0
140	235	160	254	114	290	344	170	60	470	550	42	35	30	55,0

SKF SNH plummer block housings for bearings on cylindrical seat

d_a 35 – 55 mm

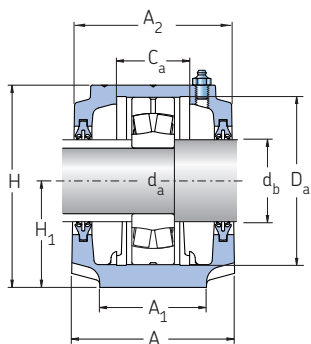

Housing with lip seals,
Type TL

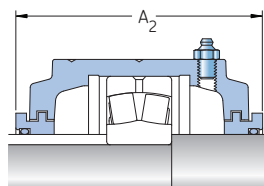

Housing with labyrinth seals,
Type TS

Shaft dia d_a	Housing with both side lip seals	Housing with lip seal + End Cover	Housing with both side labyrinth seals	Housing with labyrinth seal + End Cover	Bearing	Locating ring ¹⁾
mm						
35	-	-	SNH 207 TS	SNH 207 ATS	1207 E	FRB 8.5/72
					2207 ETN9	FRB 5.5/72
					22207 E	FRB 5.5/72
40	-	-	SNH 208 TS	SNH 208 ATS	1208 ETN9	FRB 10.5/80
					2208 ETN9	FRB 8/80
					22208 E	FRB 8/80
45	-	-	SNH 209 TS	SNH 209 ATS	1209 ETN9	FRB 5.5/85
					2209 ETN9	FRB 3.5/85
					22209 E	FRB 3.5/85
50	-	-	SNH 210 TS	SNH 210 ATS	1210 ETN9	FRB 10/90
					2210 ETN9	FRB 9/90
					22210 E	FRB 9/90
55	-	-	SNH 211 TS	SNH 211 ATS	1211 ETN9	FRB 11.5/100
					2211 ETN9	FRB 9.5/100
					22211 E	FRB 9.5/100

¹⁾ The locating ring fits the bearing in the same line only. Two locating rings are required for each housing.

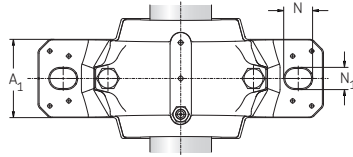
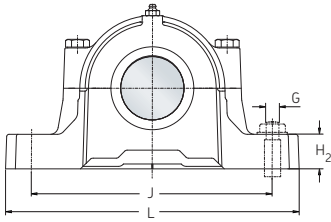

	Shaft dia d_b d_a	db	A	A_1	A_2	C_a	D_a	H	H_1	H_2	J	L	N	N_1	G	Housing Mass
	mm															kg
35		45	83	52	96	34	72	93	50	22	150	185	20	15	12	2,10
40		50	85	60	99	39	80	108	60	25	170	205	20	15	12	2,75
45		55	85	60	97	30	85	109	60	25	170	205	20	15	12	2,75
50		60	90	60	102	41	90	113	60	25	170	205	20	15	12	3,00
55		65	95	70	107	44	100	128	70	28	210	255	24	18	16	4,20

SKF SNH plummer block housings for bearings on cylindrical seat

d_a 60 – 85 mm

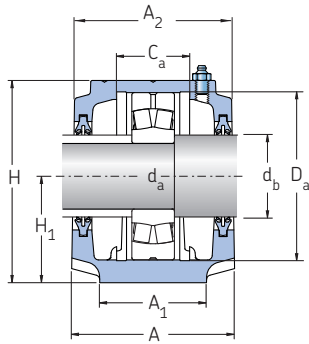

Housing with lip seals,
Type TL

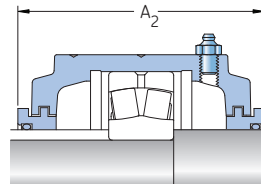

Housing with labyrinth seals,
Type TS

Shaft dia d_a	Housing with both side lip seals	Housing with lip seal + End Cover	Housing with both side labyrinth seals	Housing with labyrinth seal + End Cover	Bearing	Locating ring ¹⁾
mm						
60	-	-	SNH 212 TS	SNH 212 ATS	1212 ETN9	FRB 13/110
					2212 ETN9	FRB 10/110
					22212 E	FRB 10/110
65	-	-	SNH 213 TS	SNH 213 ATS	1213 ETN9	FRB 14/120
					2213 ETN9	FRB 10/120
					22213 E	FRB 10/120
75	-	-	SNH 215 TS	SNH 215 ATS	1215	FRB 15.5/130
					2215 ETN9	FRB 12.5/130
					22215 E	FRB 12.5/130
80	-	-	SNH 216 TS	SNH 216 ATS	1216	FRB 16/140
					2216 ETN9	FRB 12.5/140
					22216 E	FRB 12.5/140
85	-	-	SNH 217 TS	SNH 217 ATS	1217	FRB 16.5/150
					2217	FRB 12.5/150
					22217 E	FRB 12.5/150

¹⁾ The locating ring fits the bearing in the same line only. Two locating rings are required for each housing.

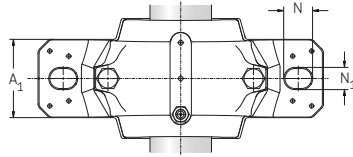
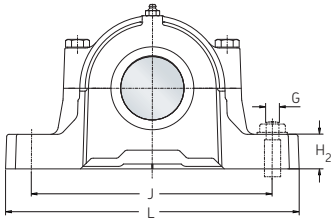

	Shaft dia	db	A	A ₁	A ₂	C _a	D _a	H	H ₁	H ₂	J	L	N	N ₁	G	Housing Mass
	d _a															
	mm															kg
60	70	105	70	117	48	110	134	70	30	210	255	24	18	16	4,75	
65	75	110	80	128	51	120	150	80	30	230	275	24	18	16	6,10	
75	85	115	80	133	56	130	156	80	30	230	280	24	18	16	6,60	
80	90	120	90	138	58	140	177	95	32	260	315	28	22	20	9,00	
85	95	125	90	143	61	150	183	95	32	260	320	28	22	20	9,50	

SKF SNH plummer block housings for bearings on cylindrical seat

d_a 90 – 120 mm

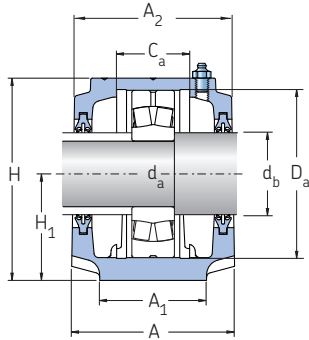

Housing with lip seals,
Type TL

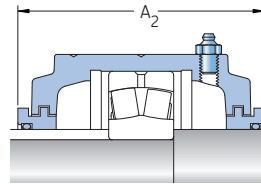

Housing with labyrinth seals,
Type TS

Shaft dia d_a	Housing with both side lip seals	Housing with lip seal + End Cover	Housing with both side labyrinth seals	Housing with labyrinth seal + End Cover	Bearing	Locating ring ¹⁾
mm						
90	SNH 218 TL	SNH 218 ATL	SNH 218 TS	SNH 218 ATS	1218	FRB 17.5/160
					2218	FRB 12.5/160
					22218 E	FRB 12.5/160
					23218 CC/W33	FRB 6.25/160
100	SNH 220 TL	SNH 220 ATL	SNH 220 TS	SNH 220 ATS	1220	FRB 18/180
					2220 M	FRB 12/180
					22220 E	FRB 12/180
					23220 CC/W33	FRB 4.85/180
110	SNH 222 TL	SNH 222 ATL	SNH 222 TS	SNH 222 ATS	1222	FRB 21/200
					2222 M	FRB 13.5/200
					22222 E	FRB 13.5/200
					23222 CC/W33	FRB 5.1/200
120	SNH 224 TL	SNH 224 ATL	SNH 224 TS	SNH 224 ATS	1224 M	FRB 22/215
					22224 E	FRB 14/215
					23224 CC/W33	FRB 5/215

¹⁾ The locating ring fits the bearing in the same line only. Two locating rings are required for each housing.

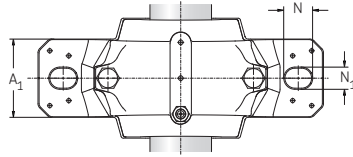
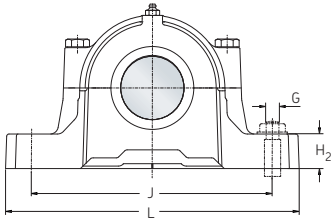

	Shaft dia d_a	db	A	A_1	A_2	C_a	D_a	H	H_1	H_2	J	L	N	N_1	G	Housing Mass
	mm															kg
90		100	140	100	158	65	160	194	100	35	290	345	28	22	20	11,8
100		115	160	110	178	70	180	218	112	40	320	380	32	26	24	17,6
110		125	175	120	191	80	200	242	125	45	350	410	32	26	24	22,0
120		135	185	120	199	86	215	271	140	45	350	410	32	26	24	26,2

SKF SNH plummer block housings for bearings on cylindrical seat

d_a 130 – 160 mm

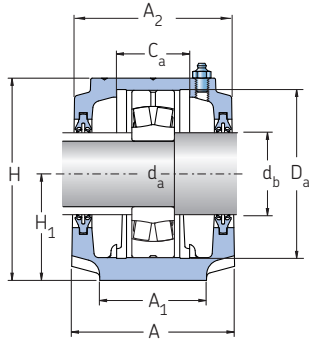

Housing with lip seals,
Type TL

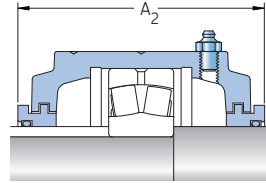

Housing with labyrinth seals,
Type TS

Shaft dia d_a	Housing with both side lip seals	Housing with lip seal + End Cover	Housing with both side labyrinth seals	Housing with labyrinth seal + End Cover	Bearing	Locating ring ¹⁾
mm						
130	SNH 226 TL	SNH 226 ATL	SNH 226 TS	SNH 226 ATS	1226 M	FRB 22/230
					22226 E	FRB 13/230
					23226 CC/W33	FRB 5/230
140	SNH 228 TL	SNH 228 ATL	SNH 228 TS	SNH 228 ATS	22228 CC/W33	FRB 15/250
					23228 CC/W33	FRB 15/250
150	SNH 230 TL	SNH 230 ATL	SNH 230 TS	SNH 230 ATS	22230 CC/W33	FRB 16.5/270
					23230 CC/W33	FRB 5/270
160	-	-	SNH 232 TS	SNH 232 ATS	22232 CC/W33	FRB 17/290
					23232 CC/W33	FRB 5/290

¹⁾ The locating ring fits the bearing in the same line only. Two locating rings are required for each housing.

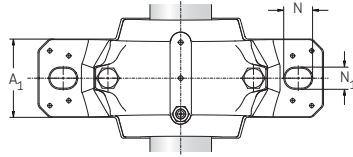
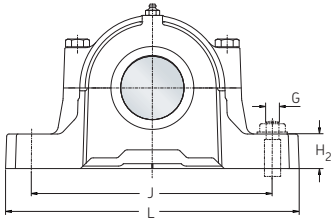

Shaft dia d_a	db	A	A_1	A_2	C_a	D_a	H	H_1	H_2	J	L	N	N_1	G	Housing Mass
mm															kg
130	145	190	130	208	90	230	290	150	50	380	445	35	28	24	33,0
140	155	205	150	223	98	250	302	150	50	420	500	42	35	30	40,0
150	165	220	160	241	106	270	323	160	60	450	530	42	35	30	49,0
160	175	235	160	254	114	290	344	170	60	470	550	42	35	30	55,0



SKF India Limited
Chinchwad, Pune 411 033, India
Tel: +91-20-6611 2500
Fax: +91-20-2747 3822
Toll Free: 1800 222 007
CIN: L29130MH1961PLC011980

www.skfindia.com

